

To Order Call: 1-800-250-5688

MCCULLOUGH COVER-UP
SERIES 1500

Operation and Maintenance Manual

Parts Catalog

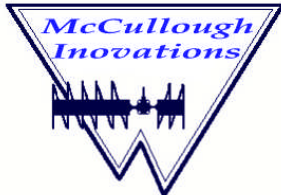

MCCULLOUGH COVER-UP SERIES 1500

1101 Sheppard Road

Burkburnett, Tx 76354

Phone 1-940-569-1770

Fax 1-940-563-5772



MCCULLOUGH COVERUP

- Complete Operation and maintenance manual for the McCullough Coverup
- 1600 Parts list included.

Call Toll Free: 1-800-250-5688

09/05/03

Contents

Page	
3.	Foreword
4.	Support
5.,6.	Warranty
7.	Introduction
8,9,10.	Safety
11.	Operation
12	Troubleshooting
13,14,15.	Parts List
16	Specifications
17.	Other Products
19.	Registration

Other products Series 1600 & 2000

2000 Series

The 2000 series was developed to handle the larger jobs of backfilling associated with the medium size trenchers. The 2000 can be adapted to nearly all of the skid steer loaders as shown and some trenchers such as the 3700 Ditch Witch.



Specifications:

Overall Length: 66" Auger
 Width: 54"
 Auger Diameter 12" Weight 350 lbs.
 Auger Choices: Offset Right, Offset Left, Centered
 HP @ 15 GPM: 20

1600 Series

The **1600** series is a larger version of the **1500** series for the operator that needs more width and weight. The 1500 is also used with the smaller skid steer loaders and tractors

Specifications:

Overall Length: 56.5"
 Auger Width: 46.5 "
 Auger Diameter: 12"
 Auger Choices: Centered
 HP @ 10 GPM 11.4
 Weight : 250 Lbs.



1500 SERIES SPECIFICATIONS

OVERALL LENGTH	49"
AUGER WIDTH	41"
VERTICAL FLOAT MOVEMENT	7 "
AUGER DIAMETER	12"
NUMBER OF INTERTWINED FLIGHTS	3
DRIVE	Dynanmic
HP @ 15GPM @ 3000 PSI	17.1
GAGE WHEEL	2" X 6"
HOSES	1/2 " X 60" 3000PSI
FINISH =	POWDER COATED
OVERALL WIDTH	41"
OVERALL HEIGHT (BACK PLATE LOWEST POSITION)	15 1/2"
OVERALL HEIGHT (BACK PLATE HIGHEST POSITION)	20 1/4"
CENTER OPENING WIDTH	4"
WEIGHT	250 LBS
HP @ 10 GPM @ 3000 PSI	11.4
SIDE LOAD CAPACITY	2400 LBS
LOAD CAPACITY	1200 LBS EACH
CONSTRUCT	STEEL, 1/8 AND 1/4

Operator's manual

Warranty

PRODUCT SUPPORT POLICY

FOR A PERIOD OF 90 DAYS FROM THE DATE OF DELIVERY BY THE DEALER TO THE ORIGINAL PURCHASER, MCCULLOUGH COVERUP WILL PROVIDE FREE REPLACEMENT PARTS THROUGH THE MCCULLOUGH COVERUP DEALER FOR ANY MCCULLOUGH COVERUP PART CONTAINING A DEFECT IN MATERIAL OR WORKMANSHIP.

Major components will have coverage for 1 year. Major components for the McCullough Coverup are defined as: **frame, augers, and wheels.** Owner's responsibility to qualify for product support are:

- Train operators according to operator's manual.
- Maintain machine according to operators manual.
- Use unit for designed applications only.

This product support policy is limited to parts returned to the dealer and determined defective on inspection by McCullough. This policy does not include transportation charges or freight and does not include consequential damages or parts damaged by improper installation, misuse, or neglect.

There are no warranties which extend beyond this description.

The engine and engine accessories and transaxle accessories are covered by the original manufacturers warrant and are not covered by McCullough Coverup.

The McCullough Coverup has been tested in various conditions for satisfactory performance. This testing does not guarantee that the equipment will perform in all conditions satisfactorily. Adequacy of the equipment for your situation should be determined before purchase.

BACK PLATE AND FLOAT BAR ASSEMBLY

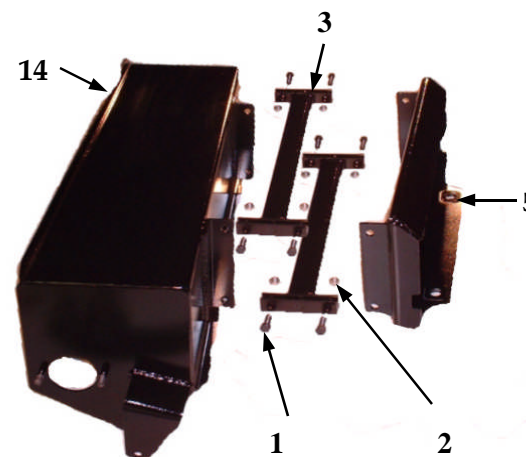

1500 SERIES PARTS LIST

No.	Part #	Description
1 ---	1501	1/2 x 1 1/2 #5 Bolt
2 --	1502	1/2" Lock Nut
3 --	1503	Float Bar
5 --	1505	Universal Adapter Plate
14 --	1514	Main Frame and Cover

RIGHT SIDE ASSEMBLY

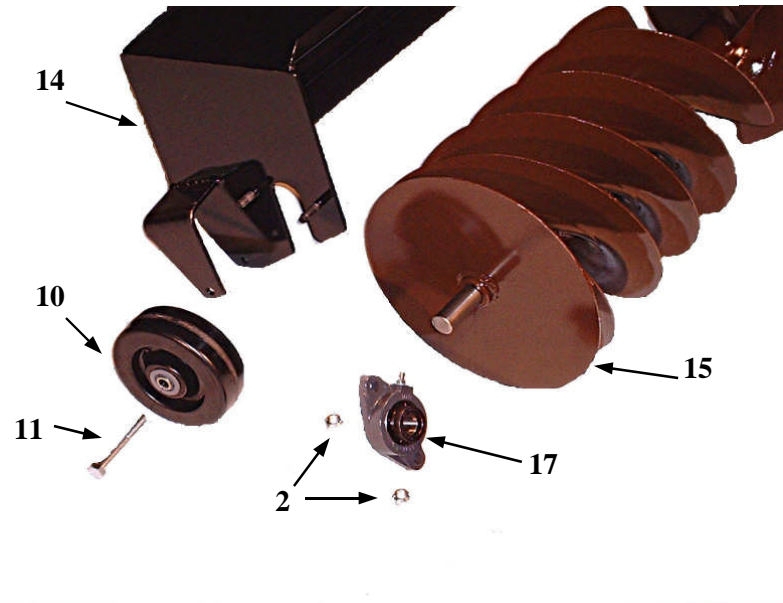

1500 SERIES PARTS LIST

No.	Part #	Description
2	--1502	1/2 Lock Nut
10	--1510	Gauge Wheel
11	--1511	1/2 x 3 1/2 #5 Bolt
14	--1514	Main Frame And Cover
15	--1515C	Auger, Center Opening
17	1517	2 Bolt Flange Bearing, 1"

INTRODUCTION

Thank you for purchasing a McCullough Coverup 1500. Read this Manual carefully to learn how to operate and service your coverup machine correctly. Failure to do so could result in personal injury or equipment damage.

This Manual should be considered a permanent part of your coverup machine.

Measurements in this manual are US customary units.

Right and left sides are determined by facing in the direction of forward travel.

Record serial Numbers to help trace the machine if it is stolen. File Numbers in a safe place.

SAFETY

RECOGNIZE SAFETY INFORMATION

This is the safety-alert symbol. When you see this symbol on your machine or in this manual, be alert to the potential for personal injury. Follow recommended precautions and safe operating practices. Use common sense.



UNDERSTAND SIGNAL WORDS !

A signal word, DANGER OR CAUTION is used with the safety – alert symbol. DANGER OR WARNING safety signs are located near specific hazards. General precautions are listed on CAUTION safety messages in this manual.

FOLLOW SAFETY INSTRUCTIONS

Carefully read all of this manual.

Learn how to operate the coverup machine and how to use controls properly. Do not let anyone operate the machine without instruction and training.

Keep equipment in proper working condition. Unauthorized modifications to the coverup machine may impair the function and/or safety and affect the machine life.

If you do not understand any part of this manual and need help, contact your sales representative.

LEFT SIDE ASSEMBLY

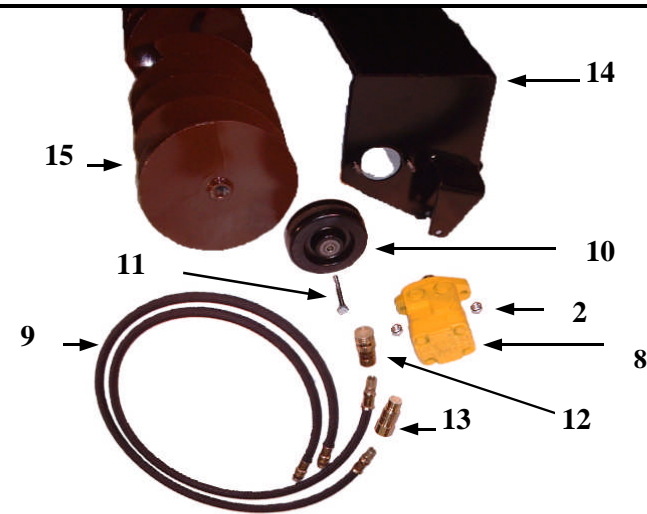

1500 SERIES PARTS LIST

No.	Part #	Description
2--	1502	1/2" Lock Nut
8--	1508	White Hydraulic Motor
9--	1509	1/2 X 60" Hydraulic Hoses
10--	1510	Gauge Wheel
11--	1511	1/2 X 3 1/2 #5 Bolt
12--	1512	1/2 Female Quick Coupler
13--	1513	1/2 Male Quick Coupler
14--	1514	Main Frame and Cover

TROUBLE SHOOTING

IF AUGER DOESN'T TURN

Check hydraulic lines and hydraulic Flow.

Check woodruff key on motor shaft. If the key has sheared, remove motor and replace key.

Shut Engine down and check auger for any foreign objects.

INSPECT COVERUP MACHINE BEFORE YOU OPERATE IT.

Check for loose, worn, damaged, or missing parts and correct any problems before operating the coverup.



PROTECT CHILDREN

Keep children and others away when using your coverup machine.

Before engaging controls **stop and make sure area is free of children.**

Do not let children ride on coverup machine.

AVOID ROTATING AUGERS

Do not put hands or feet near augers—especially when auger is engaged and turning.

Do not attempt to clear objects from auger with engine running.

Remove objects that may become lodged in auger.

Always stop engine before attempting to adjust auger.

**LISTEN ! LOOK ! WAIT !**

LISTEN for sound of rotating auger before you approach coverup.

LOOK at auger and be sure that it is stopped.

WAIT to be sure all parts have stopped moving before approaching

SERVICE COVERUP MACHINE SAFELY

Understand service procedure before you do the work.

Keep work area floor clean and dry.

Help prevent injury from moving parts during service:

- Do not lubricate or service machine while parts are moving.
- Keep hands, feet, and clothing from power-driven parts.
- Disengage power.

Safely support coverup machine parts that must be raised for service.

KEEP ALL PARTS IN GOOD CONDITION AND PROPERLY INSTALLED

- Fix damage immediately.
- Replace worn or broken parts.
- Remove grease, oil , or dirt from parts.

REMEMBER “THINK SAFETY”.

Operation

CONNECTING ATTACHMENT

1. Hook coverup attachment to mounting plate and secure pins.
2. Connect hoses.
3. Turn on hydraulics and check rotation of auger.
4. Look at end of the machine where motor is attached. Auger should be turning clockwise.
5. Center arrow with ditch.

ATTACHMENTS WITH PARALLEL BARS

Let the boom down until the parallel bars are parallel with the ground.

Rotate tilt control until desired auger height is reached.
Drive forward.

Parallel bars have a 7" float, so boom may need to be adjusted to keep parallel with the ground.

ATTACHMENTS WITHOUT PARALLEL BARS

Center on ditch.

Put the boom control in float position.

Use tilt control to regulate the height from ground.

Drive forward.