

Sold by:



**MCCULLOUGH COVER-UP SERIES
2000**

1101 Sheppard Road
Burkburnett, Tx 76354
Phone 1-940-569-1770
Fax 1-940-563-5772
E-Mail coverup@mcculloughcoverup.com

MCCULLOUGH COVER-UP SERIES 2000

**Operation and
Maintenance
Manual**

**Parts Catalog
2000 Series**



MCCULLOUGH COVERUP

- Complete Operation and maintenance manual for the McCullough Coverup
- 2000 Parts list included.

Call Toll Free: 1-800-250-5688

01/01/01

Table of Contents

1. WARRANTY
2. SAFETY PRECAUTIONS
3. MAINTENANCE
4. OPERATING INSTRUCTIONS
5. TROUBLE SHOOTING
6. PARTS LIST
7. SPECIFICATIONS

Coverup 1000

The Coverup 1000 walk behind

The 1000 is the perfect machine for the walk behind trenchers. Designed for use in turf areas for the irrigation industry to reduce time and labor. The 1000 can cover 60 feet of trench in one minute all day long and never get tired. It's smooth easy operation reduces operator fatigue to a minimum. It weighs only 250 lbs, 42" width with a five speed transaxle and Honda engine makes it fast and reliable.



Other products Series 1500 & 3000

3000 Series

The 3000 series was developed to handle the larger jobs of backfilling associated with the larger ditches. The 3000 can be adapted to nearly all of the skid steer loaders as shown ..



Specifications:

Overall Length: Auger Width:
Auger Diameter Weight
Auger Choices: Offset Right, Offset Left, Centered
HP @

1500 & 1600 SERIES

The 1500 Series is a smaller version of the 1600 series for the operator that needs a little less width and weight. The 1500 is also used with the smaller skid steer loaders and tractors



Specifications:

Overall Length: 49"
Auger Width: 41"
Auger Diameter: 12"
Auger Choices: Offset Right,
Offset Left, Centered
HP @ 10 GPM 11
Weight : 250 Lbs.

INTRODUCTION

Thank you for purchasing a **McCullough Coverup 2000**
Read this Manual carefully to learn how to operate and service your coverup machine correctly. Failure to do so could result in personal injury or equipment damage.

This Manual should be considered a permanent part of your coverup machine.

Measurements in this manual are US customary units.

Right and left sides are determined by facing in the direction of forward travel.

Record serial Numbers to help trace the machine if it is stolen. File Numbers in a safe place.

WARRANTY

PRODUCT SUPPORT POLICY

FOR A PERIOD OF 90 DAYS FROM THE DATE OF DELIVERY BY THE DEALER TO THE ORIGINAL PURCHASER, MCCULLOUGH COVERUP WILL PROVIDE FREE REPLACEMENT PARTS THROUGH THE MCCULLOUGH COVERUP DEALER FOR ANY MCCULLOUGH COVERUP PART CONTAINING A DEFECT IN MATERIAL OR WORKMANSHIP.

Major components will have coverage for 1 year. Major components for the McCullough Coverup are defined as : FRAME, AUGERS, AND WHEELS. Owner's responsibility to qualify for product support are:

1. Train operators according to Operator's manual..
2. Maintain machine according to operators manual.
3. Use unit for designed applications only.

This product support policy is limited to parts returned to the dealer and determined defective on inspection by McCullough. This policy does not include transportation charges or freight and does not include consequential damages or parts damaged by improper installation, misuse, or neglect.

There are no warranties which extend beyond this description.

The engine and engine accessories and transaxle accessories are covered by the original manufacturers warrant and are not covered by McCullough Coverup.

The McCullough Coverup has been tested in various conditions for satisfactory performance. This testing does not guarantee that the equipment will perform in all conditions satisfactorily. Adequacy of the equipment for your situation should be determined before purchase.

2000 SERIES SPECIFICATIONS

OVERALL LENGTH	66"
AUGER WIDTH	54"
VERTICAL FLOAT MOVEMENT	7 "
AUGER DIAMETER	12"
NUMBER OF INTERTWINED FLIGHTS	3
DRIVE	DYNAMIC
HP @ 10GPM @ 3000 PSI:	15
HP @ 15 GPM @ 3000PSI:	20
FINISH =	POWDER COATED
OVERALL WIDTH	20"
OVERALL HEIGHT	19"
AUGER CHOICES:	OFFSET RIGHT, OFFSET LEFT, CENTERED.
CENTER OPENING WIDTH	6"
WEIGHT	350 LBS
SIDE LOAD CAPACITY	2400 LBS
LOAD CAPACITY	1200 LBS EACH
CONSTRUCTION	STEEL, 3/16 AND 1/4
GAGE WHEELS	6" X 2"

SKID STEER UNIVERSAL MOUNT

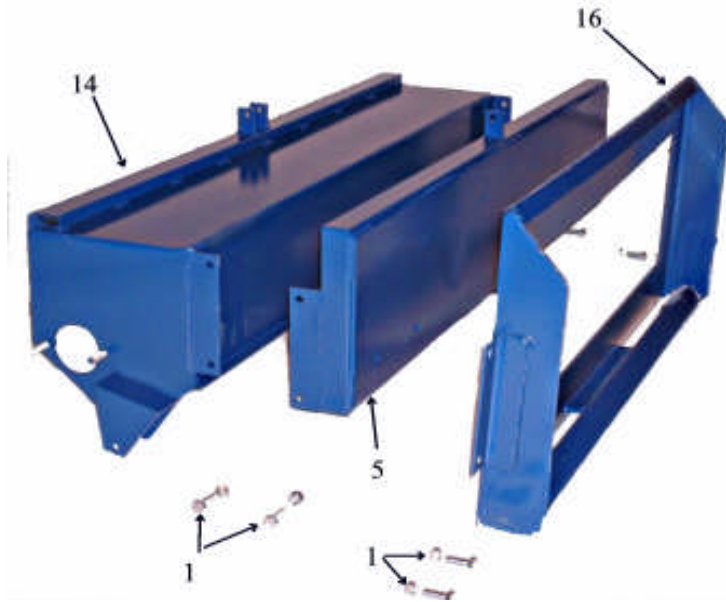

NO.	PART NO.	DISCRIPTION
1	20001	1/2" X 1 1/2 " GRADE 5 MACHINE BOLTS AND SELF LOCKING NUTS
5	20005	BACKPLATE
14	20014	MAIN FRAME AND COVER
16	20016	UNIVERSAL SKID STEER QUIK ATTACH PLATE

SAFETY

RECOGNIZE SAFETY INFORMATION

This is the safety-alert symbol. When you see this symbol on your machine or

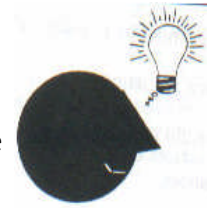

in this manual, be alert to the potential for personal injury. Follow recommended precautions and safe operating practices. Use common sense.

UNDERSTAND SIGNAL WORDS !

A signal word, DANGER OR CAUTION is used with the safety - alert symbol. DANGER OR WARNING safety signs are located near specific hazards. General precautions are listed on CAUTION safety messages in this manual.

FOLLOW SAFETY INSTRUCTIONS

Carefully read all of this manual.

Learn how to operate the coverup machine and how to use controls properly. Do not let anyone operate the machine without instruction and training.

Keep equipment in proper working condition. Unauthorized modifications to the coverup machine may impair the function and/or safety and affect the machine life.

If you do not understand any part of this manual and need help, contact your sales representative.

INSPECT COVERUP MACHINE BEFORE YOU OPERATE IT.

Check for loose, worn, damaged, or missing parts and correct any problems before operating the coverup.



PROTECT CHILDREN

Keep children and others away when using your coverup machine.

Before engaging controls stop and make sure area is free of children.

Do not let children ride on coverup machine.

AVOID ROTATING AUGERS

Do not put hands or feet near augers—especially when auger is engaged and turning.

Do not attempt to clear objects from auger with engine running.

Remove objects that may become lodged in auger before operating.

Always stop engine before attempting to adjust auger.

LIFT SIDE ASSEMBLY

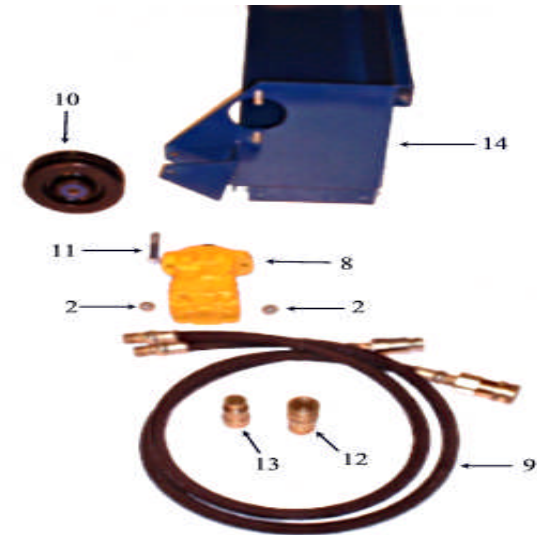

NO.	PART NUMBER	DISCRIPTION
2	200002	1/2" LOCK NUT
8	200008	HYDRAULIC MOTOR
9	200009	1/2" X 6 FT HYDRAULIC HOSES
10	200010	6" X 2" GAUGE WHEEL
11	200011	1/2" X 3 1/2" GRADE 5 WHEEL AXLE BOLT
12	20012	FEMALE QUICK COUPLER
13	20013	MALE QUICK COUPLER
14	20014	MAIN FRAME COVER

FRONT SIDE ASSEMBLY

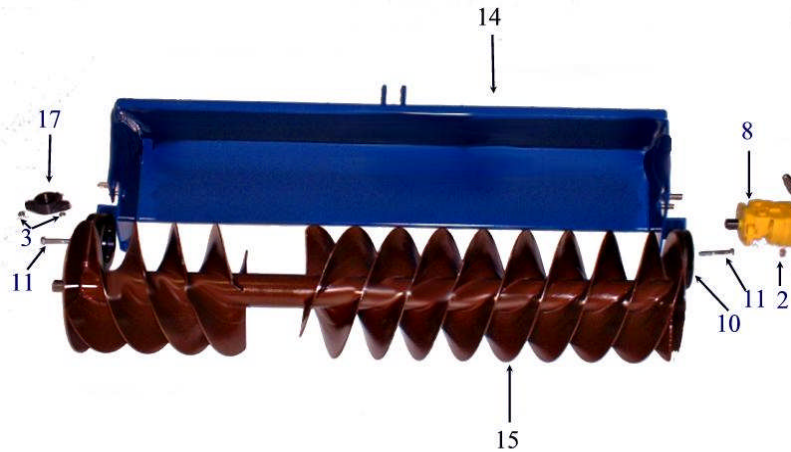

NO.	PART NUMBER	DISCRIPTION
2	200002	1/2" LOCK NUTS
3	200003	7/16 " LOCK NUTS
8	200008	HYDRAULIC MOTOR
10	200010	6"X 2" GUAGE WHEEL
11	200011	1/2' X 3 1/2" GRADE 5 WHEELAXLE BOLT
14	200014	MAIN FRAME AND COVER
15	200015R	AUGER, LONG SIDE ON RIGHT
	200015C	AUGER, CENTER OPENING
	200015L	AUGER, LONG SIDE ON LEFT
17	200017	2 BOLT FLANGE BEARING, 1"

LISTEN ! LOOK !WAIT !



LISTEN for sound of rotating auger before you approach coverup.



LOOK at auger and be sure that it is stopped.



WAIT to be sure all parts have stopped moving before approaching

SERVICE COVERUP MACHINE SAFELY

Understand service procedure before you do the work.

Keep work area floor clean and dry.

Help prevent injury from moving parts during service:

– Do not lubricate or service machine while parts are

KEEP ALL PARTS IN GOOD CONDITION AND PROPERLY INSTALLED

- Fix damage immediately.
- Replace worn or broken parts.
- Remove grease, oil , or dirt from parts.

REMEMBER "THINK SAFETY".

Operation

CONNECTING ATTACHMENT

1. Hook coverup attachment to mounting plate and secure pins.
2. Connect hoses.
3. Turn on hydraulics and check rotation of auger.
4. Look at end of the machine where motor is attached. Auger should be turning clockwise.
5. Center arrow with ditch.

OPERATION

Center on ditch.

Put the boom control in float position.

Use tilt control to regulate the height from ground.

Drive forward.

When you have reached the end of the ditch, and are moving to a new ditch, leave the tilt control in position and lift the boom. After repositioning over the ditch and centering the auger arrow, put the boom in float position and continue backfilling.

TROUBLE SHOOTING

IF AUGER DOESN'T TURN

Check hydraulic lines and hydraulic flow.

Check woodruff key on motor shaft. If the key has sheared, remove motor and replace key.

Shut Engine down and check auger for any foreign objects.